

PVVK-CFA FLEX VENT KIT INSTRUCTIONS

EFFECTIVE DATE OCTOBER 2006

INSTRUCTIONS MUST BE LEFT WITH THE OWNER FOR FUTURE REFERENCE AFTER INSTALLATION

The flex vent kit is a flexible vent hose that is 42" in length. The flex vent kit will be used when installing a Mantis into an existing fireplace. The flex vent kit can be cut down, but can only be cut from one end.

Cement PVC Joints

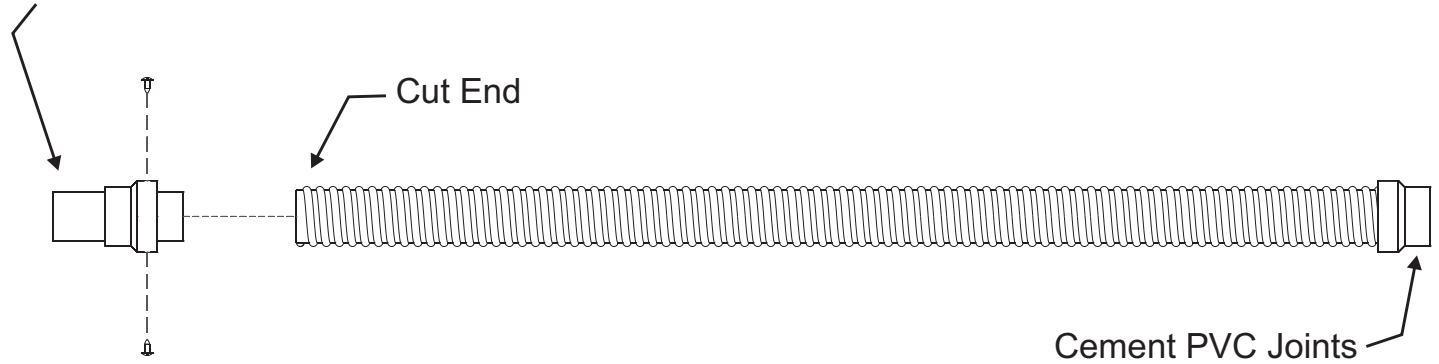

Once length is determined, install two (2) 10 x 1/2" screws into the adaptor assembly to secure the adaptor assembly to the flex hose. Using PVC cement, cement all PVC joints of the flex vent kit to the remaining PVC vent run.

Determining Minimum Vent Height Above the Roof

WARNING: Major U.S. building codes specify minimum chimney and/or vent height above the rooftop. These minimum heights are necessary in the interest of safety.

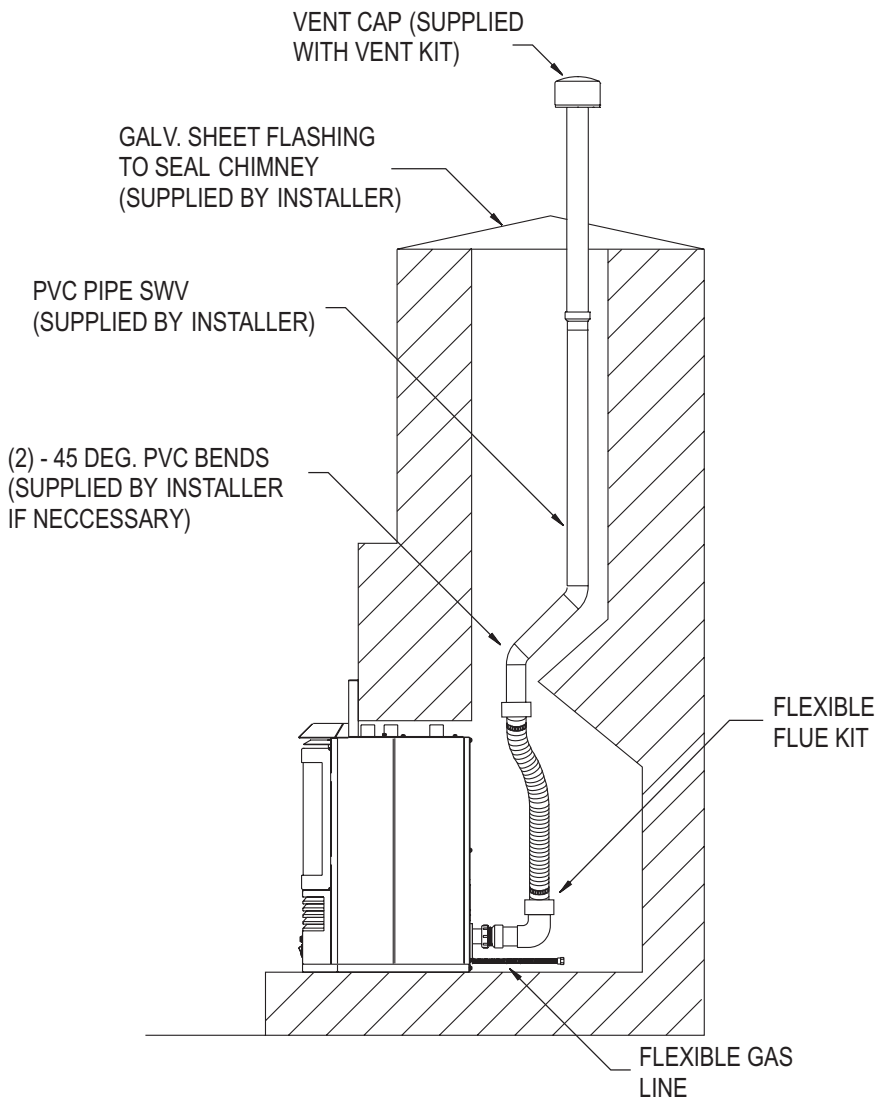

ROOF PITCH	H (Min.)
Flat to 6/12	12" (305mm)
6/12 to 7/12	15" (381mm)
Over 7/12 to 8/12	18" (457mm)
Over 8/12 to 16/12	24" (610mm)
Over 16/12 to 21/12	36" (914mm)

Venting for Existing Fireplace Installation